

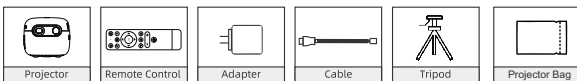

User Manual

PACKAGE CONTENTS



DESCRIPTION OF THE PROJECTOR

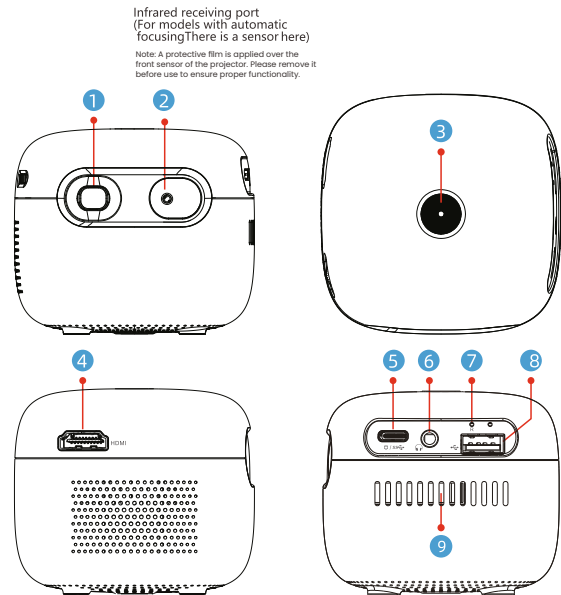

- 1 Projection lens
- 2 Remote receiver
- 3 On/Off
- 4 HDMI Port
- 5 Type C Port
- 6 3.5mm headphone input
- 7 Reset
- 8 USB Port
- 9 Air outlet

DEVICE CONNECTION

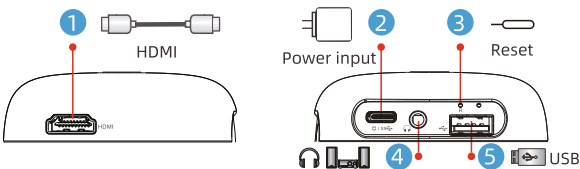

- **HD Signal Connection**
Connect an external HD source, such as a TV box, laptop, or gaming console, to the projector.
- **Power Supply**
Plug the standard power adapter into the projector to supply power.
- **Troubleshooting:**
No Display / System Crash / Abnormal Screen Output
If the Android system fails to display properly or crashes:
 - Option 1: Press and hold the power button on the top of the projector for 5 seconds to force a shutdown. The system will automatically restart to resolve the issue.
 - Option 2: Using a card pin or similar object, briefly press the reset button labeled "R" located on the side of the projector. After the projector is turned off, press and hold the power button to restart the device.
- **Audio Output**
Connect headphones or external sound systems via the audio output interface.
- **USB Device Connection**
Connect external USB devices, such as USB drives, keyboards, or mice, using the USB port.

POWERING ON/OFF

- 1.Ensure Power Connection**
Confirm that the projector is connected to the supplied power adapter.
- 2.Startup Methods**
You can power on the projector using either of the following methods:
 - oPress and hold the power button located on the top of the projector.
 - oPress the power button on the remote control. (Ensure the power adapter is plugged in.)

POWERING OFF THE PROJECTOR

- To turn off the projector, use either the device or the remote control:
1.Standard Shutdown
 - Press the power button once.
 - A shutdown menu will appear on screen. Use the navigation buttons (◀/▶) on the remote control to select the desired option.
 - Press "OK" to confirm your selection. The projector will shut down accordingly.
- 2.Alternative Method**
 - Press the power button on the projector or remote.
 - Select the "Shut Down" option from the on-screen menu.
 - Press the power button again to confirm. The projector will turn off.

INDICATOR DESCRIPTION

Adapter powered	charging	Red light is always on
	Charging complete (standby)	All lights are off
	Charging complete (power on)	Pink light is always on
Internal battery powered	Power off	All lights are off
	Power on	Blue light is always on
Fault state	Abnormal temperature	Slow flashing red light
	Fan is abnormal	Red light flashes quickly
Bluetooth speaker mode (battery powered)	Pairing	Blue light flashes quickly
	Pairing complete	Blue light is always on
Bluetooth speaker mode (adapter powered)	Pairing (while charging)	Red and blue lights flash alternately
	Pairing complete (while charging)	Pink light is always on

REMOTE CONTROL ILLUSTRATION

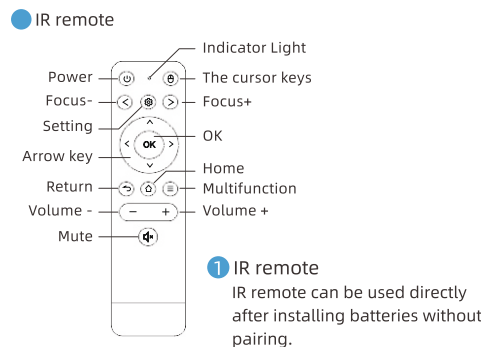

PROJECTION SIZE AND DISTANCE

Projection size distance table (without keystone correction)			
Projection distance (m)	Screen width (m)	Screen height (m)	Diagonal screen size (inches)
0.50	0.417	0.260	19
1.00	0.833	0.519	39
1.50	1.250	0.779	58
2.00	1.667	1.039	78

Projection distance reference image

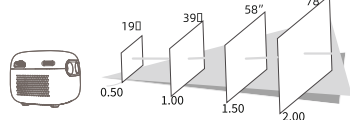

Unit: meter
The actual environment is complex, the parameters are for reference only

GENERAL FAULT DESCRIPTION

General fault description	
No screen display System crash	1. Power off and then power on, restart the system. 2. Press the power button for more than 5s to power off, and then restart the system. 3. Press the button in the R hole on the side of the projector with a fine needle, and reset the projector.
Can not be controlled by controller	1. Please check the battery of the remote control is installed correctly or replace it with a new battery and test again. 2. Please test the remote against the remote control receiving window of the projector to confirm.
Can not power on	1. Please check the power adapter is well connected to the projector. 2. Please confirm the battery of the projector is in the out of power state, connect the adapter to charge for 30 minutes before turning it on.
Can not charging	Please use the original standard power adapter for charging.
Prompt the temperature is too high or automatically shut down	Please check the cooling air outlet and inlet of the projector are blocked.
Other system failures	Please contact the after-sales number of the purchase channel.

NOTICE

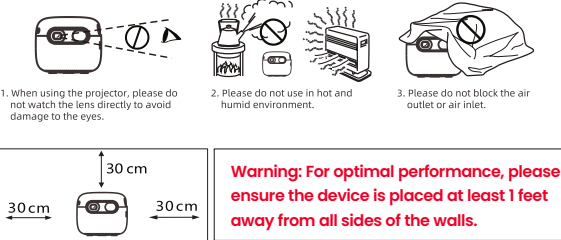

Installation Guidelines

To ensure optimal performance and ventilation, maintain a minimum clearance of 30 cm on all sides between the projector and any walls or obstructions.

Safety Warnings

- Please observe the following safety precautions when operating the projector:
- Do not block the ventilation slits or openings of the projector.
 - Avoid using abrasive materials such as scrubs, paraffin, or solvents to clean the device.
 - Do not operate the projector under the following conditions:
 - In extremely hot, cold, or humid environments.
 - If indoor temperature is not within the range of 5°C to 40°C.
 - Where relative humidity exceeds 80% or in conditions that may cause condensation.
 - In areas with high levels of dust, dirt, or airborne particles.
 - Near equipment that emits strong magnetic fields.
 - In direct sunlight exposure.

SAFETY INSTRUCTION:

This projector contains a built-in battery. Do not operate or store it in high-temperature or high-humidity environments.
If the product remains unused for an extended period, ensure it is charged at least once every three months to maintain battery health.

MAINTENCE AND CARE

- Cleaning the Projector**
Proper maintenance of your projector will enhance its performance and longevity. Follow these guidelines for cleaning:
1. Cleaning the Lens
Use a soft, dry microfiber cloth to gently wipe the lens.
If necessary, apply a small amount of lens-cleaning solution to the cloth—never directly on the lens.
2. Cleaning the Exterior
Wipe the projector body with a soft, dry cloth.
Avoid using abrasive cleaners or solvents that could damage the surface.
3. Cleaning the Ventilation Openings
Use a small brush or compressed air to remove dust from the ventilation grilles.Ensure vents remain unobstructed to prevent overheating.
4. Cleaning the Remote Control
Use a slightly damp cloth to clean the remote.
Avoid direct moisture contact with buttons or the battery compartment.

General Maintenance Tips

- Store the projector in a cool, dry place when not in use.
- Keep all cables properly organized to prevent damage.
- Ensure the power cord is unplugged before cleaning or relocating the projector.

TROUBLESHOOTING

Issue	Possible Cause	Solution
No Power	Loose connection	Check and secure power cable
No Image	Wrong input source	Select the correct source via remote
Blurry Image	Improper focus	Adjust focus using remote
No Sound	Mute is ON	Unmute via remote

For further assistance, contact customer support.

WARRANTY INFORMATION

- The warranty covers defects in materials and workmanship.
- Damage due to physical impact, liquid exposure, or misuse is not covered.
- Repairs, not replacements, are provided under the warranty period.